

The perfect connection for pipes

NORMACONNECT® – Pipe Connections

Both industrial and OEM manufacturers rely on NORMACONNECT® pipe connections as a safe means of connecting pipes in various applications that feature different materials and sizes.



Precision

NORMACONNECT® – Pipe Connections

NORMACONNECT® ARS Exhaust pipe clamps

ARS exhaust pipe clamps connect pipes fitted into each other securely and reliably. They are also used to connect pipes that are subject to extreme thermal fluctuations and therefore, are especially suitable for connecting, for example, exhaust pipes and silencers in the automotive industry.

Short description of technical features



- 1** Either M8, M10 or M12 bolt
= depending on the required clamping force
- 2** One-piece clamp band
= uniform contact pressure on the pipe circumference
= high efficiency with regard to system tightness

- 3** 1 Bolt
= easy assembly
- 4** Rounded band edges
= hose protection and protection against injury

Materials

W1*	W2*	W3	W4*	W5*
X	X**		X**	X**

* Chrome VI-free / ** On request

NORMACONNECT® – Pipe Connections

Bolt types

For information which bolt is supplied for each clamping range please refer to the table of sizes.

Bolt	Hammer head/ Flange nut	Hexhead bolt/ Flange nut	Hexhead bolt/ Hexagonal nut	Loose fit washer*
M 8	X	X		X**
M 10			X	X
M 12			X	X

* underneath the bolt head and the nut

** underneath the bolt head (only applicable to several diameters!)



M8 version with hammer head bolt



M10 and M12 version with hex head bolt

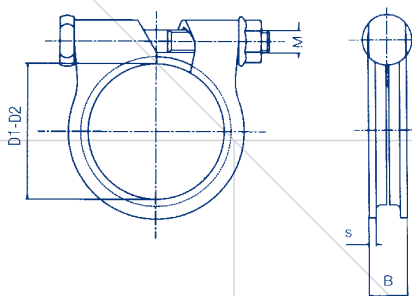
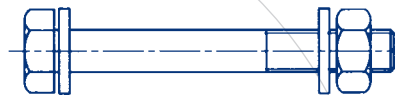
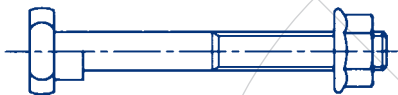

The advantages at a glance

- Made in one piece
- Persistent contact on the pipe surface
- Uniform contact pressure on the pipe circumference
- No asymmetric deformation of the pipe

NORMACONNECT® – Pipe Connections

Technical features

Corrosion resistance

Material	Corrosion resistance in salt spray testing
W1	Min. 144 h



Applications in the automotive industry

- Connecting pipes that are fitted into each other
- Connecting the exhaust pipe and the silencer

NORMACONNECT® – Pipe Connections

Survey of sizes, band widths & materials NORMACONNECT® ARS

Description	Clamping Range D1–D2 in mm	Packaging IC	S*	B*	Recommended Tightening torque	W1
ARS M8-27 W1	24–27	100	1.5	10.4	8–10 Nm	X
ARS M8-33 W1	30–33	100	1.5	10.4		X
ARS M8-36 W1	33–36	100	2.0	12.8	10–15 Nm	X
ARS M8-39.5 W1	36.5–39.5	100	2.0	12.0		X
ARS M8-42 W1	39–42	100	2.0	12.8		X
ARS M8-45 W1	42–45	100	2.5	13.6	15–20 Nm	X
ARS M8-46 W1	43–46	100	2.5	12.8		X
ARS M8-47 W1	44–47	100	2.5	13.6		X
ARS M8-49 W1	45–49	100	2.5	13.2		X
ARS M8-51 W1	48–51	100	2.5	13.2		X
ARS M8-54 W1	51–54	100	2.5	13.2		X
ARS M8-55 W1	52–55	100	2.5	13.6		X
ARS M8-58 W1	55–58	100	2.5	13.2		X
ARS M8-64 W1	61–64	100	2.5	13.2		X
ARS M8-71 W1	68–71	100	2.5	13.2		X
ARS M10-64 W1	60–64	100	3.0	15.0	20–25 Nm	X
ARS M10-71 W1	67–71.5	100	3.0	15.0		X
ARS M12-114 W1	106–114	50	3.0	19.0	35–40 Nm	X

* Refer to diagram on p. 63

Enquiries/ordering:

When making enquiries or placing orders please indicate as follows:

	1. Type	2. Bolt	3. Clamping Range	4. Material
Example	ARS	M8	47	W1